

# FOR LEASE

**252 Boerum St**  
(b/t Bushwick Pl & White St)  
**East Williamsburg, Brooklyn**

# 2,188 SF

# Flex Space



**Description:** Lot Dimensions: 25' x 87.5'  
Newly Renovated  
Stucco Façade/Glass Storefront  
Bldg Dimensions: 25' x 87.5'  
13' Ceiling Height

White Ceramic Tile Throughout  
New Electric & Plumbing  
New Restroom  
M1-1 Zoning  
C/O Reads "General Retail Store"

**Subway:** 2.5 Blocks from the Montrose Ave **L** Subway Station

**Asking Price:** \$6,500.00 per Month

**Jacques Wadler**  
Exclusive Agent:  
**516-650-1123**  
**jwadler@krgnyc.com**

**Vincent Lopez**  
Exclusive Agent:  
**917-523-5772**  
**vlopez@krgnyc.com**

**252 BOERUM ST. EAST WILLIAMSBURG, BROOKLYN**



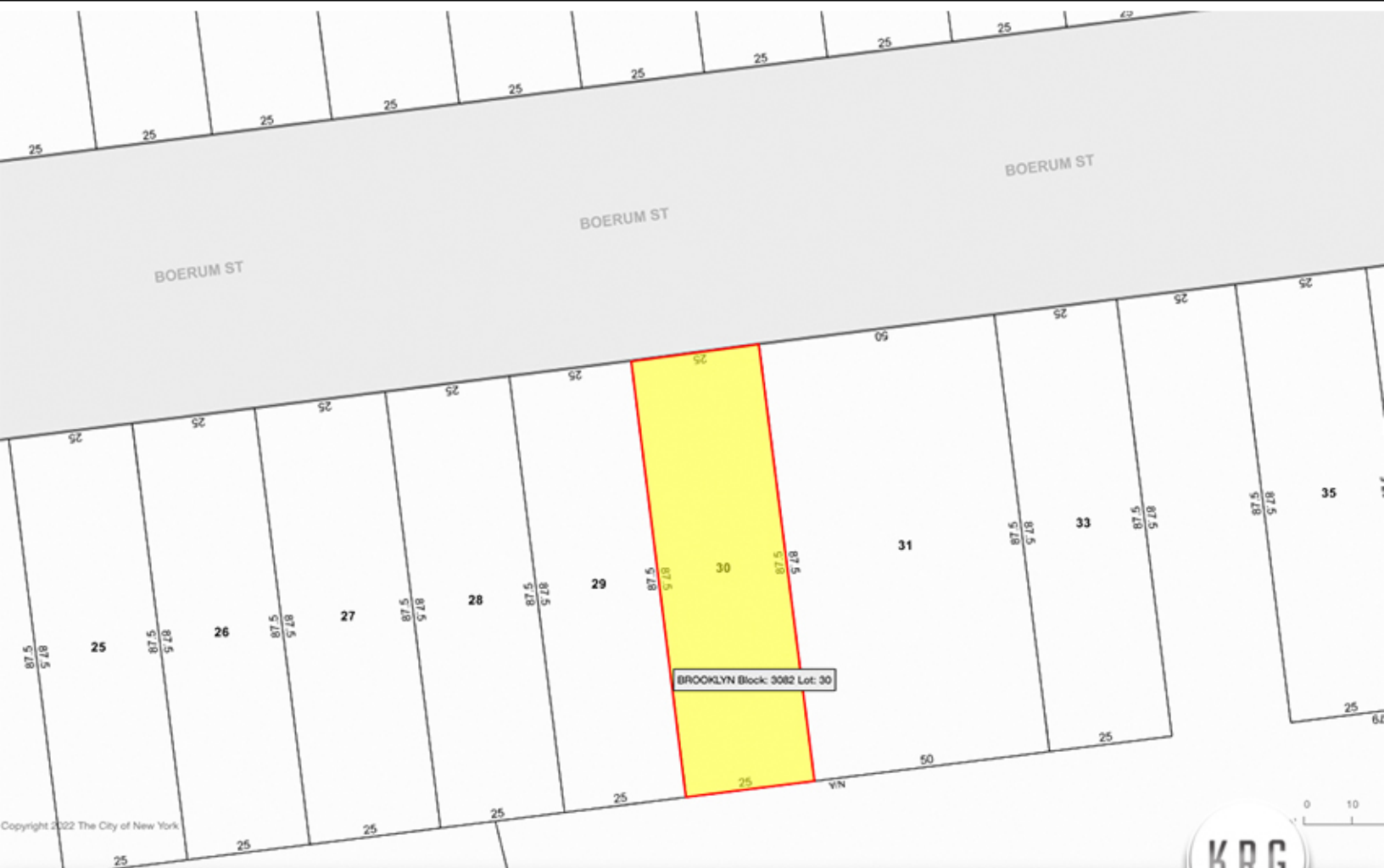

## 252 BOERUM ST. EAST WILLIAMSBURG, BROOKLYN

